

II-MANHOLE CHIMNEY for Temporary Load HR-30  
II-CON DE TRECERE pentru sarcina temporara HR-30

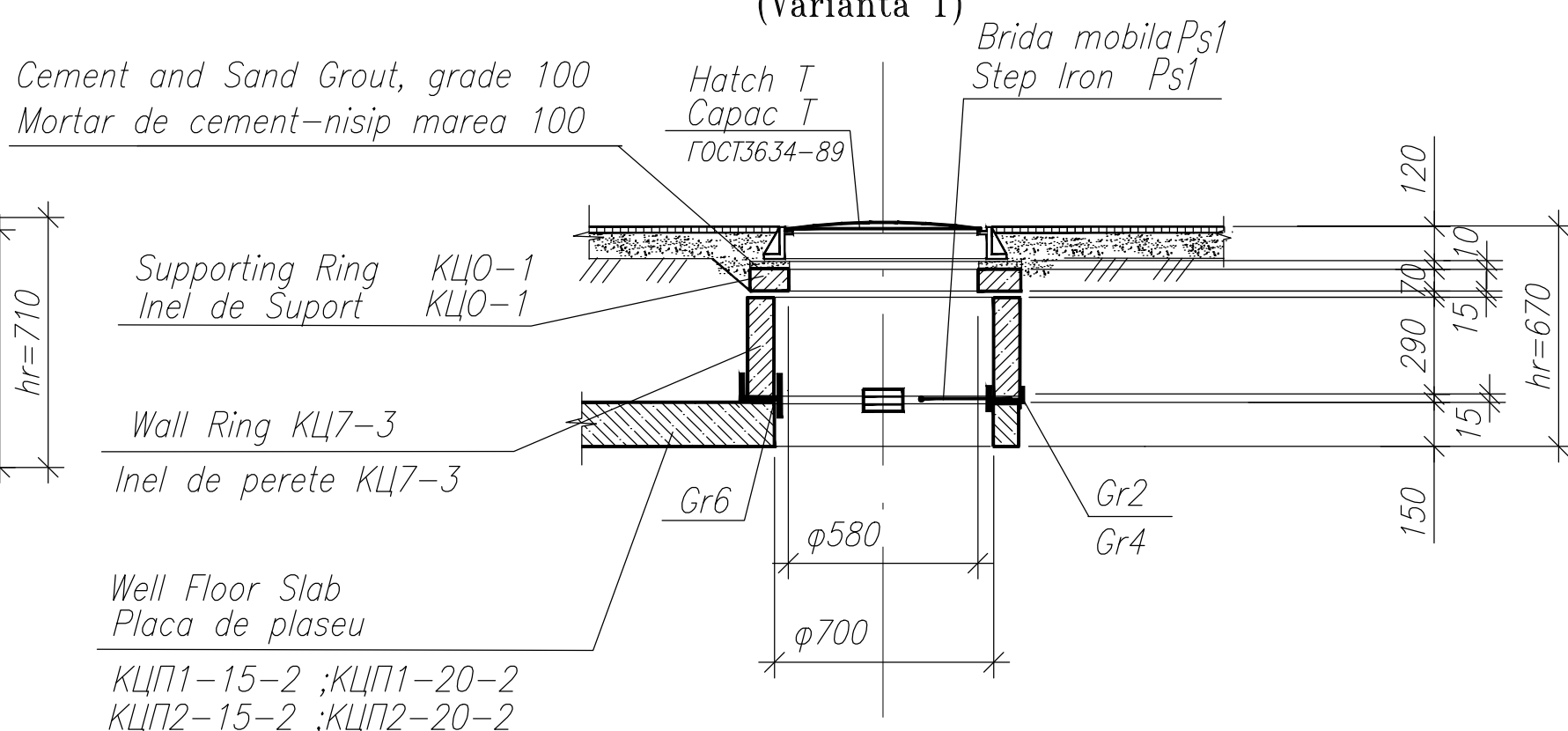

Step-ladder C-1...C-11  
Scara de acces C-1...C-11



(2nd variant)  
(Varianta 2)



Gr2; Gr4; Gr6

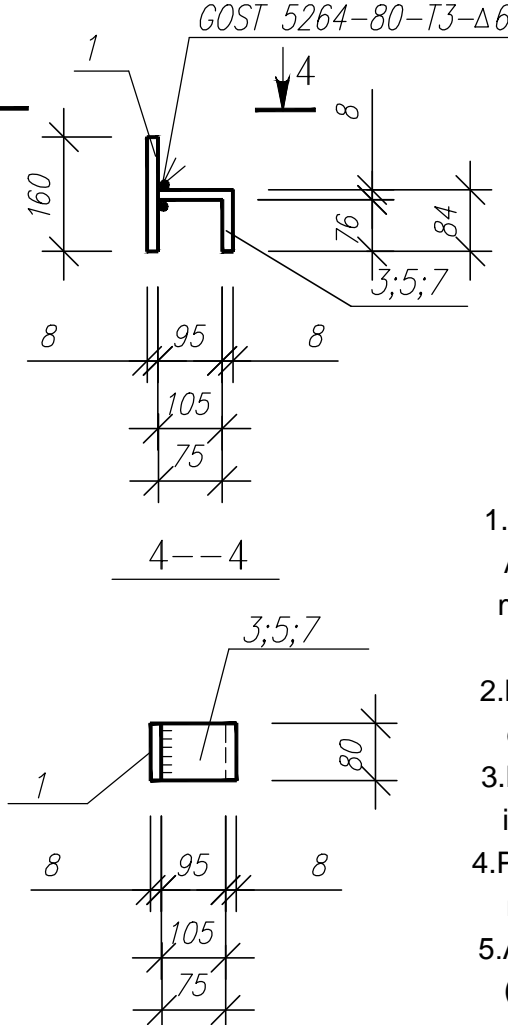

Ps1  
ep Iron  
ida mobila

### Specification connecting works

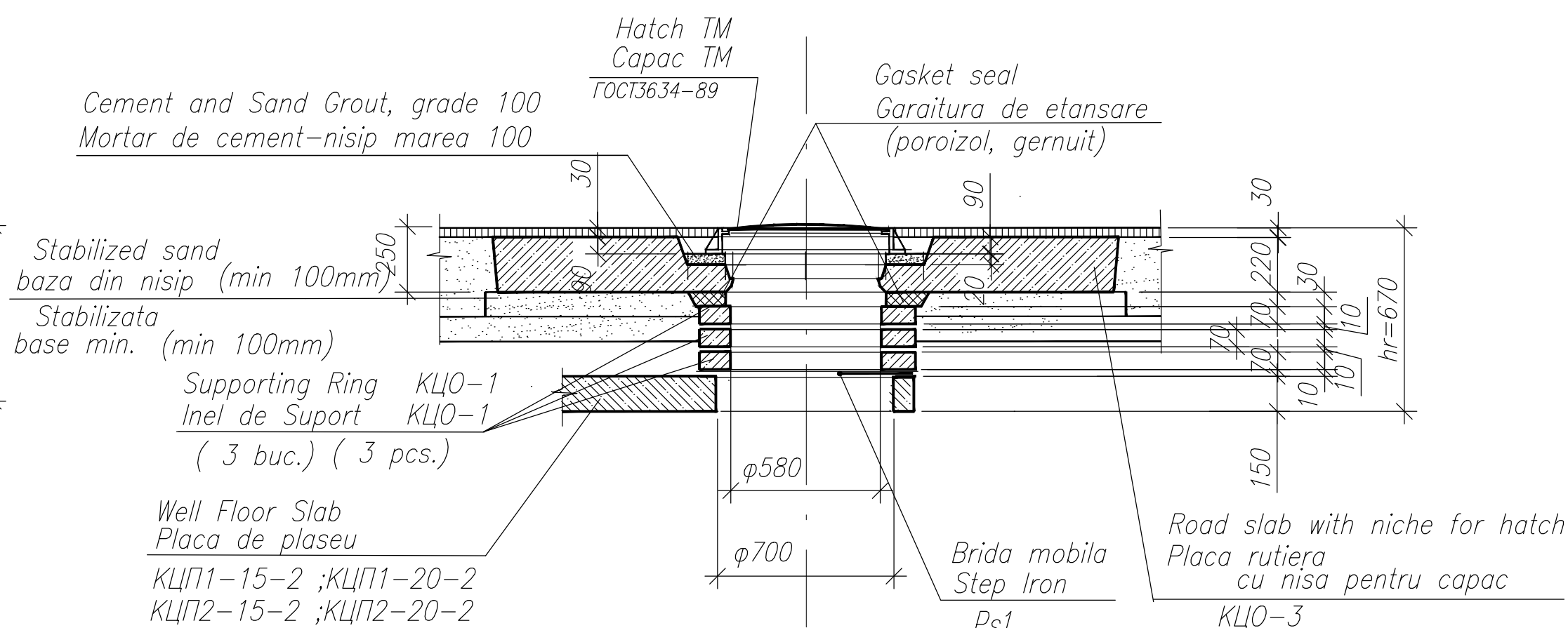



### Specificatia pieselor de imbinare

Poz.	Denumire	C-tea buc.	Masa un.,kg
	<u>Gr1 (pentru <math>\phi 1500</math>)</u>		2.1
1	Foaila <u><math>8 \times 80 \times 160</math> GOCT 19903-74 C235FOCT 27772-88</u>	2	0.80
2	Foaila <u><math>8 \times 80 \times 95</math> GOCT 19903-74 C235FOCT 27772-88</u>	1	0.5
	<u>Gr2 (pentru <math>\phi 1500</math>)</u>		1.7
1	Foaila <u><math>8 \times 80 \times 160</math> GOCT 19903-74 C235FOCT 27772-88</u>	1	0.80
3	Foaila <u><math>8 \times 80 \times 180</math> GOCT 19903-74 C235FOCT 27772-88</u>	1	0.9
	<u>Gr3 (pentru <math>\phi 2000</math>)</u>		2.1
1	Foaila <u><math>8 \times 80 \times 160</math> GOCT 19903-74 C235FOCT 27772-88</u>	2	0.80
4	Foaila <u><math>8 \times 80 \times 105</math> GOCT 19903-74 C235FOCT 27772-88</u>	1	0.53
	<u>Gr4 (pentru <math>\phi 2000</math>)</u>		1.75
1	Foaila <u><math>8 \times 80 \times 160</math> GOCT 19903-74 C235FOCT 27772-88</u>	1	0.80
5	Foaila <u><math>8 \times 80 \times 190</math> GOCT 19903-74 C235FOCT 27772-88</u>	1	0.95
	<u>Gr5 (pentru <math>\phi 700</math>)</u>		1.7
1	Foaila <u><math>8 \times 80 \times 160</math> GOCT 19903-74 C235FOCT 27772-88</u>	2	0.80
6	Foaila <u><math>8 \times 80 \times 75</math> GOCT 19903-74 C235FOCT 27772-88</u>	1	0.1
	<u>Gr6 (pentru <math>\phi 700</math>)</u>		1.6
1	Foaila <u><math>8 \times 80 \times 160</math> GOCT 19903-74 C235FOCT 27772-88</u>	1	0.80
7	Foaila <u><math>8 \times 80 \times 160</math> GOCT 19903-74 C235FOCT 27772-88</u>	1	0.8
	<u>Brida mobilă P51</u>		
	<u>16Al GOCT5781-82 L=1000 C235FOCT 19903-74</u>	1	1.56

Step-ladders specification C- 1... C-11					
Designation	H	Brand	Sizes,mm		Weight kg.
			A	n	
Metal Step-ladder for for wells  3660 -6/1-CBA.H1	1500	C-1	1200	3	17.9
	1800	C-2	1500	4	14.5
	2100	C-3	1800	5	21.34
	—	C-4	2250	6	25.64
	2700	C-5	2400	7	27.8
	2400	C-6	2100	6	24.6
	3000	C-7	2700	8	31.1
	4500	C-8	4200	13	47.4
	4800	C-9	4500	14	50.4
	—	C-10	3000	9	37.8
	—	C-11	3600	13	40.6

Step-ladders specification    ЦП-1...ЦП-5				
Designation	Brand	Sizes,mm		Weight kg.
		B	n	
Metal Step-ladder and Staircase for wells with fire hydrants  3660 -6/1-CBA.H1	ЦП-1	1800	7	17.3
	ЦП-2	2100	8	21.8
	ЦП-3	2400	9	24.6
	ЦП-4	2700	10	27.4
	ЦП-5	L50x5		23.5

					3660 - 6 /1 - CBA.H2										3660 - 6 /1 - CBA.H2														
					Realizărea sistemului de alimentare cu apă în mun. Bălți.Apeduct de pe str. Fiodor Dostoievski pe str.Independenței, str. Sportivă pîna la str. N. Gluhovski [etapa I de la str. Alexandr Puskin pîna la str. N. Gluhovski].										Realizărea sistemului de alimentare cu apă în mun. Bălți.Apeduct de pe str. Fiodor Dostoievski pe str.Independenței, str. Sportivă pîna la str. N. Gluhovski [etapa I de la str. Alexandr Puskin pîna la str. N. Gluhovski].														
Sciri	Con	Foia	N.doc.	Semnet	Data											Sciri	Con	Foia	N.doc.	Semnet	Data								
					Reinforced concrete constructions										Construcții din beton armat														
					Faza Foala Foi										Faza Foala Foi														
					WP										PE														
					 <b>INTEKNAUCA S.A.</b> <small>INTEKNAUCA S.A. este o companie cu capital 100% românesc</small>										 <b>INTEKNAUCA S.A.</b> <small>INTEKNAUCA S.A. este o companie cu capital 100% românesc</small>														
					Chisinau 2021										Chisinau 2021														
Sp.prin.	Novicova			04.21	Camine din b-a prefabricat. TipI,II,III. Piese de imbinare.					Sp.prin.	Novicova			04.21	Camine din b-a prefabricat. TipI,II,III. Piese de imbinare.														
Elabor.	Novicova			04.21						Elabor.	Novicova			04.21															
					"INTEKNAUCA" S.R.L.										"INTEKNAUCA" S.R.L.														
					Chisinau 2021										Chisinau 2021														